

- ### 1 Safety Notice
- Please read Manual carefully before you use the projector.
 - To ensure stable power supply, please use national standard power cable and power cord with grounding.
 - Please use the right power cord for the projector, improper power cord may cause damage to the projector.
 - Please do not disassemble the machine yourself, otherwise the company will not undertake warranty service.
 - Do not look directly at the projector lens while the machine is working, it might cause damage to your eyes.
 - To prevent clogging the projector vents, do not cover them with cloth, carpet or other materials.
 - This projector does not have waterproof function, please keep it away from rain, moisture and other items containing liquid such as vase, cup, etc.
 - To prevent electric shock, please keep the projector away from rain, water or moisture.
 - Cut off the power supply if do not use this projector for a long time.
 - Use the original foam or other unit-shock material to protect projector if you need transport this projector.
 - If you find the projector have problems, please contact with the supplier, do not repair by yourself.
 - To extend the projector life span and protect your eyesight, we suggest you may have a break after 3-4 hours using.

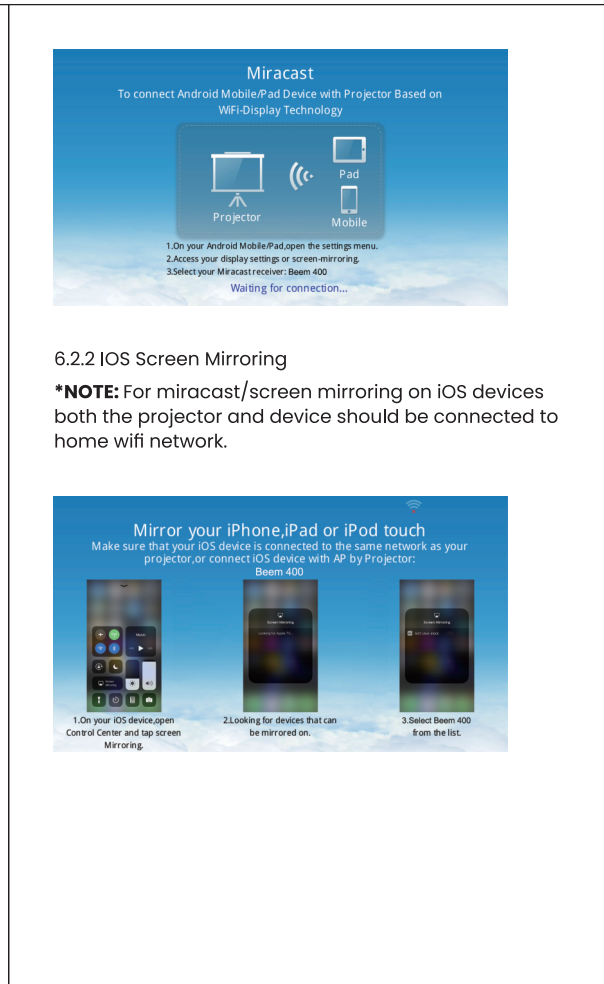
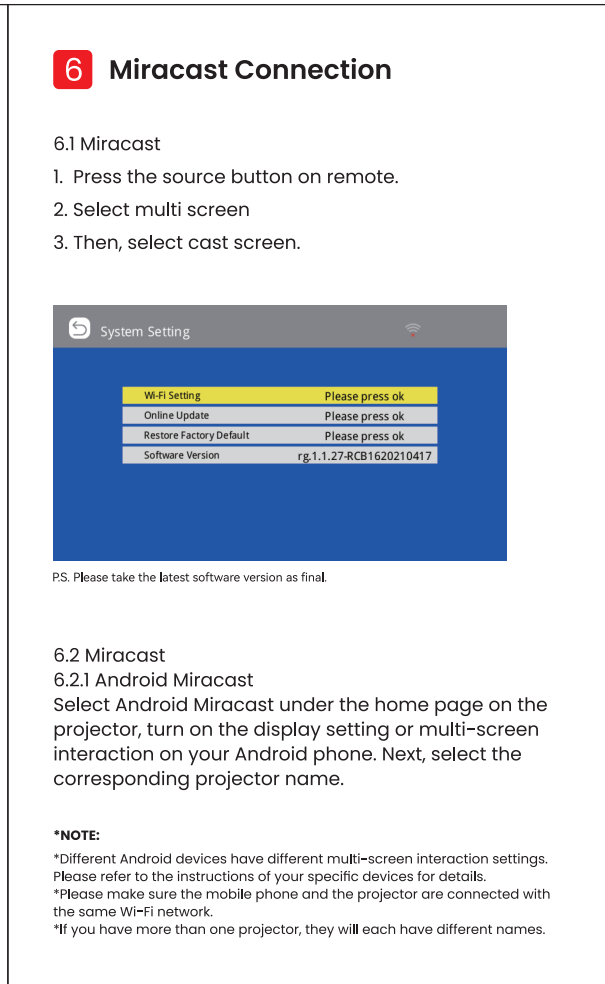
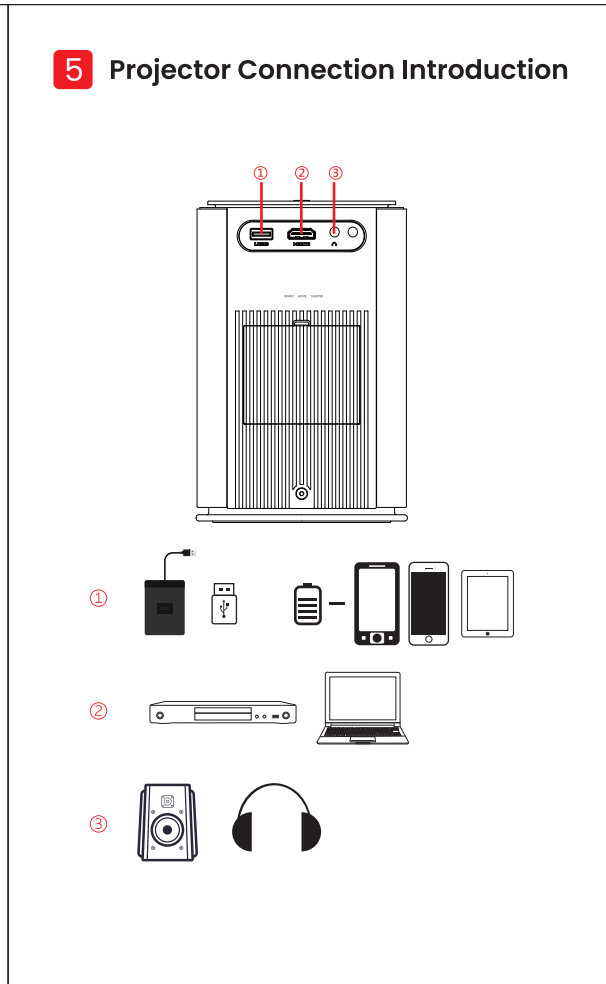
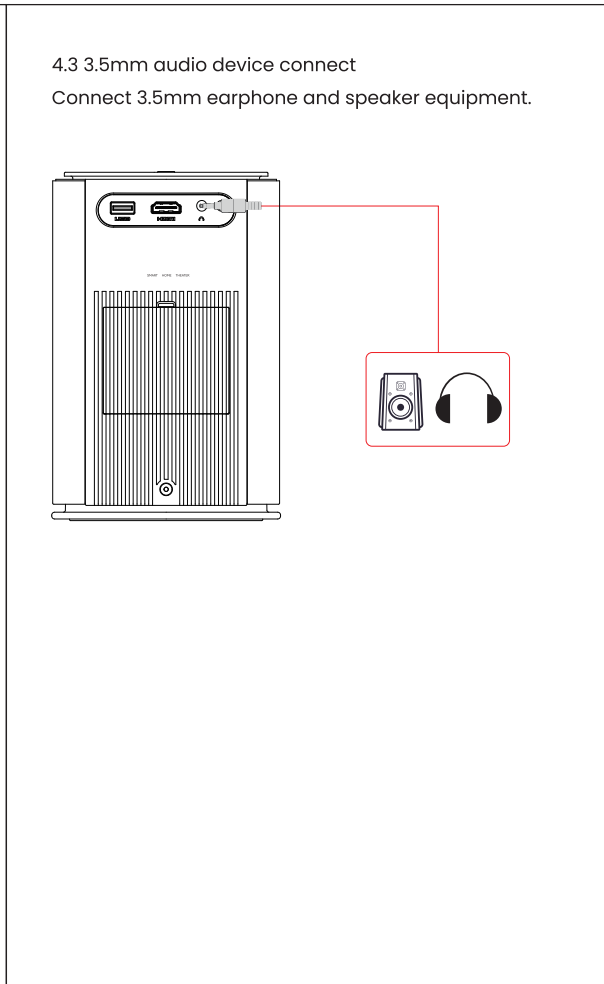
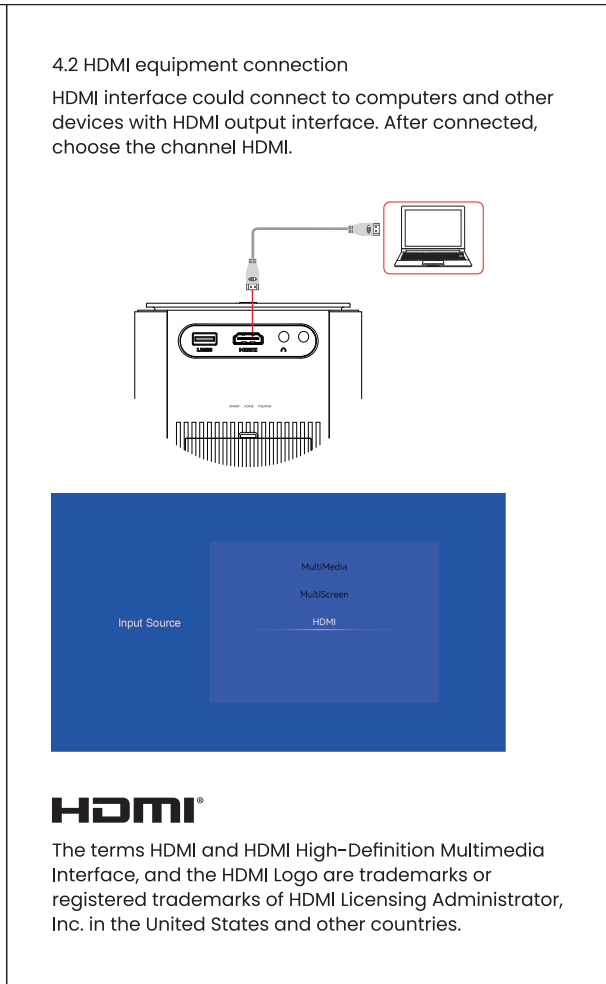
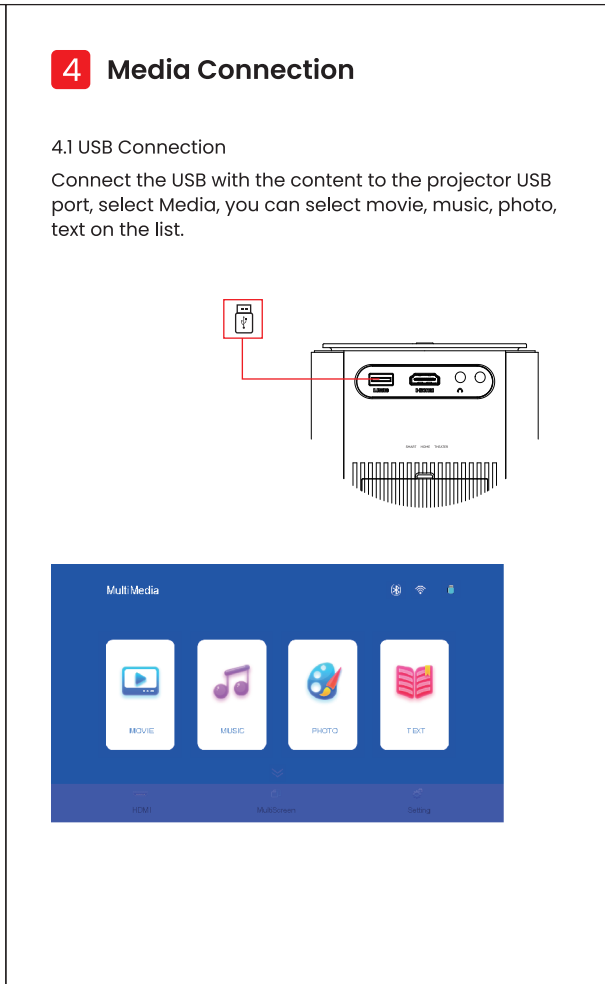
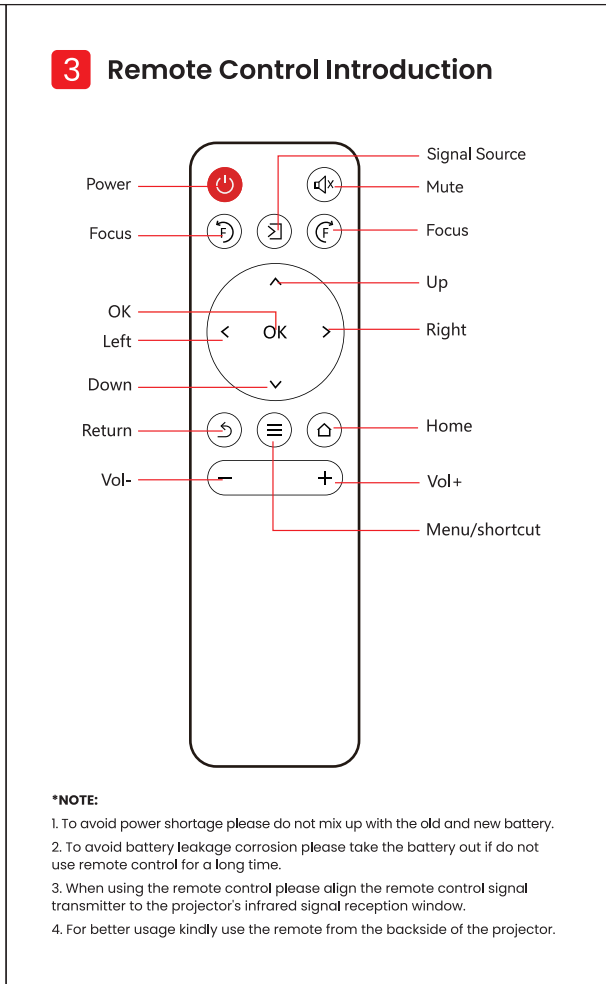
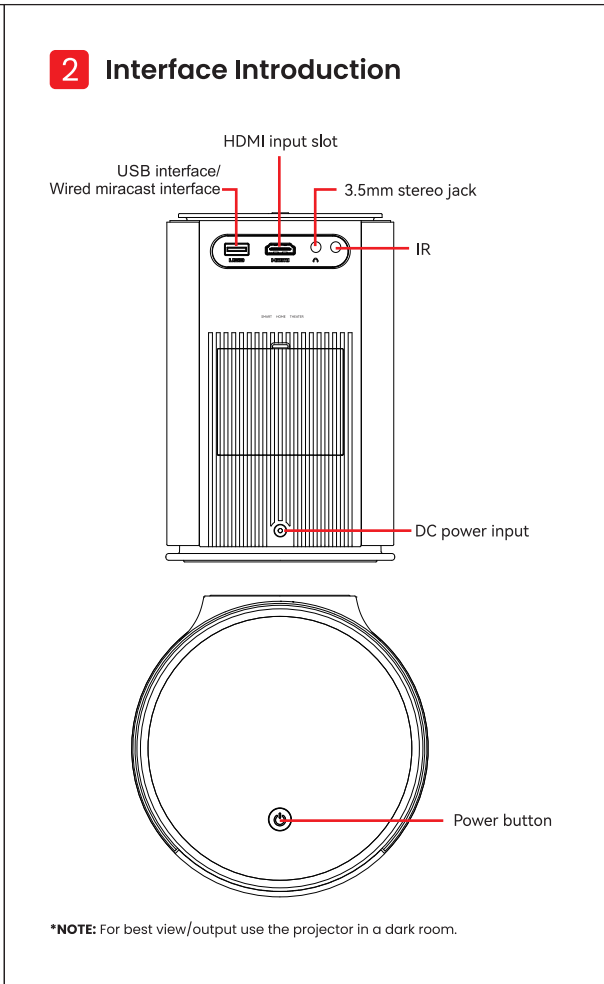

PORTRONICS

www.portronics.com
For Support
Visit : www.portronics.com
Email : help@portronics.com
Contact No. : +91 9555245245, 011-42413131
(Working Hrs. : Monday – Saturday 10:00am – 6:00pm)

CE, RoHS, WEEE, Recycle

E-Waste Management
E: info@3recycler.com
For E-Waste & ROHS compliance refer to www.portronics.com/ewaste

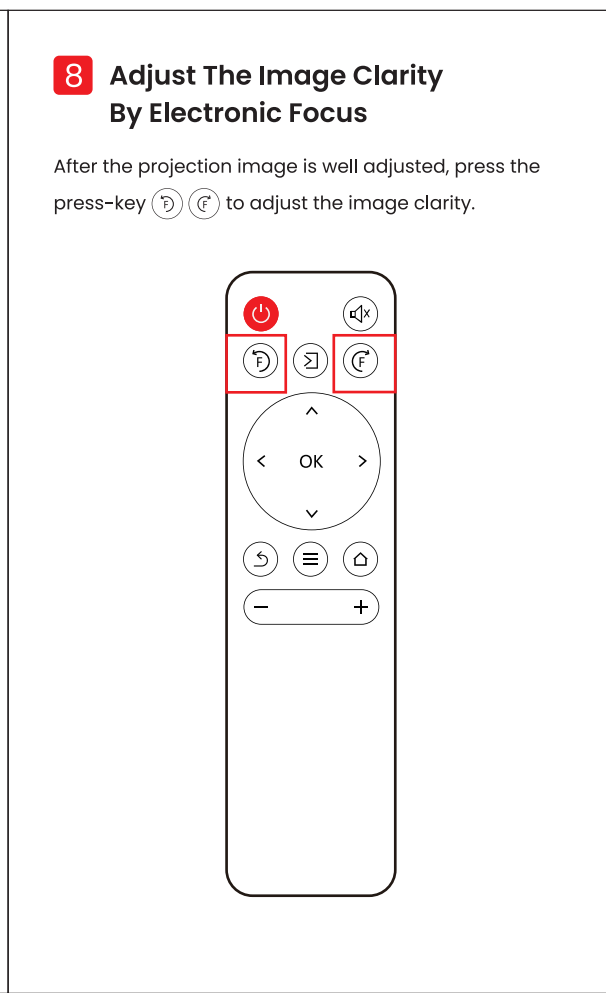
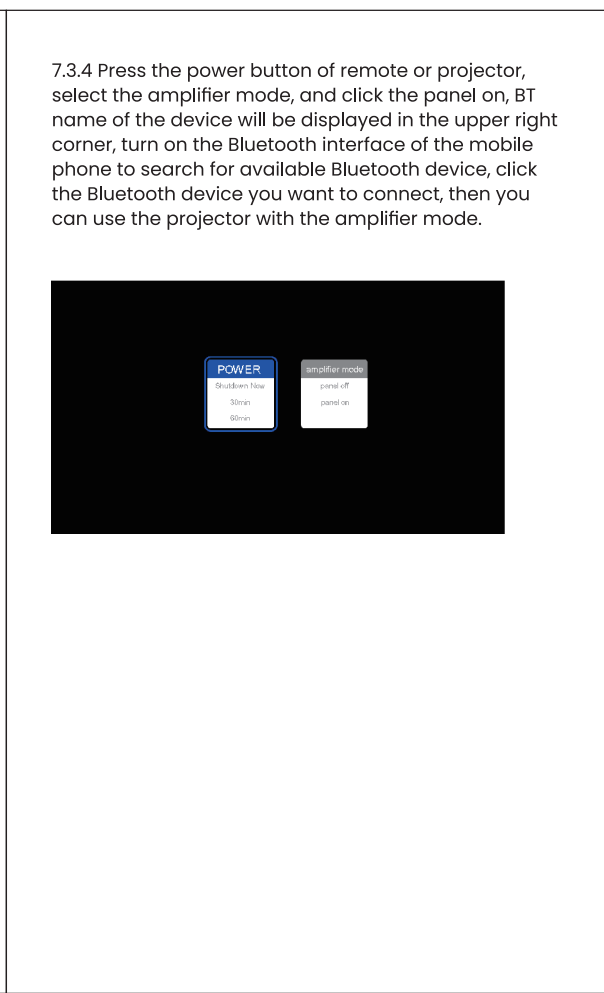
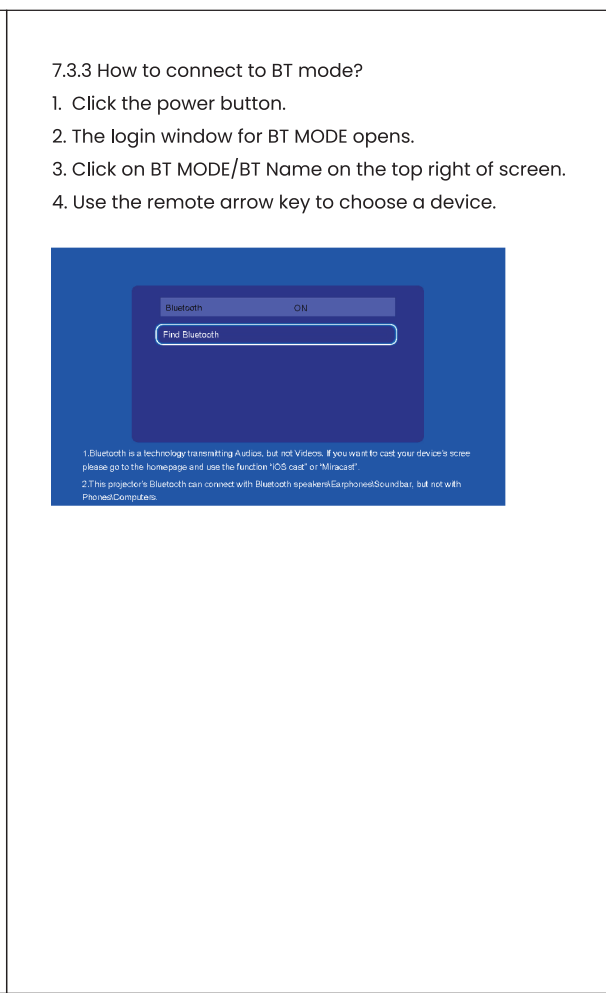
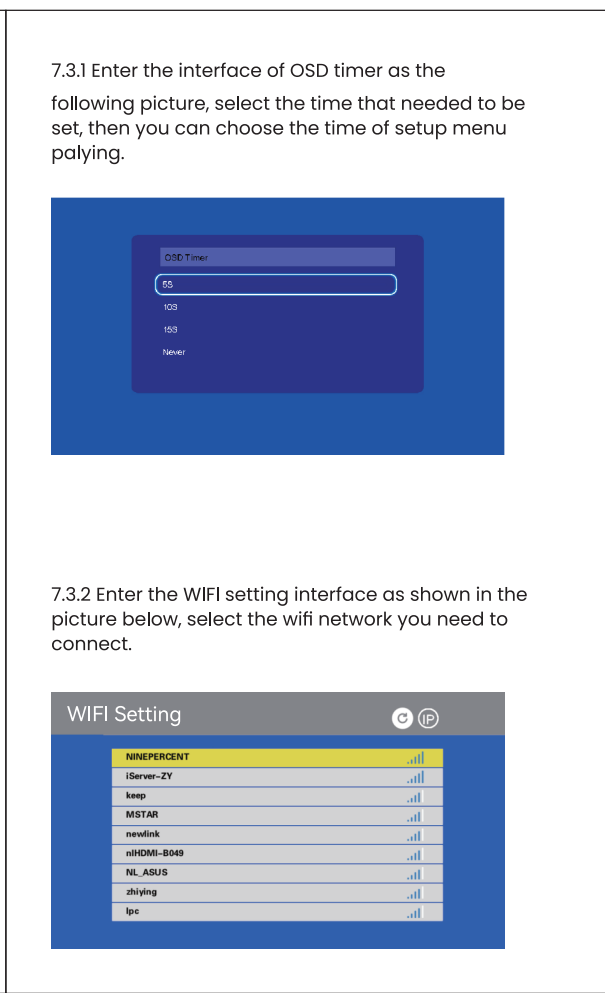
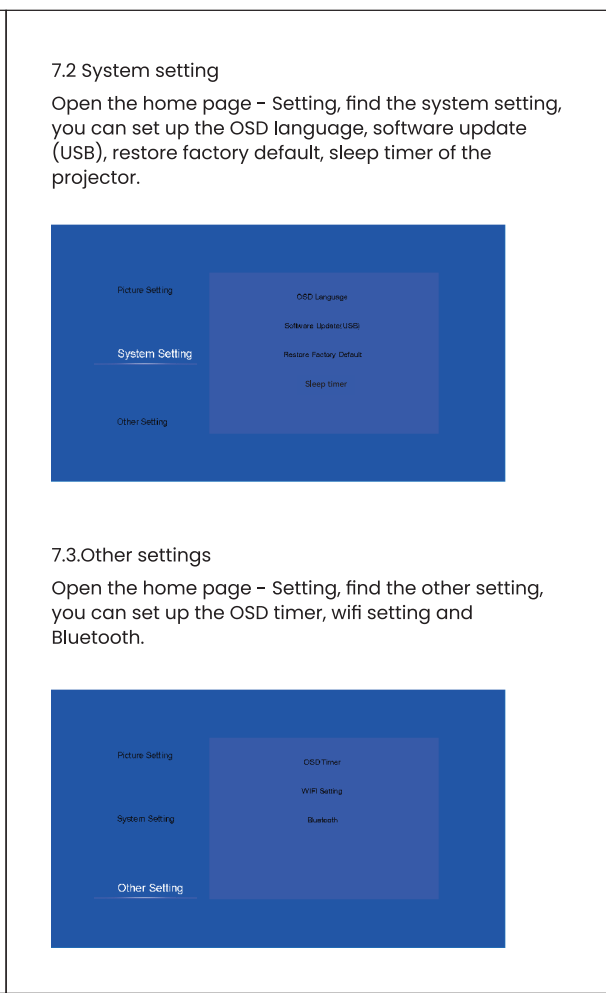
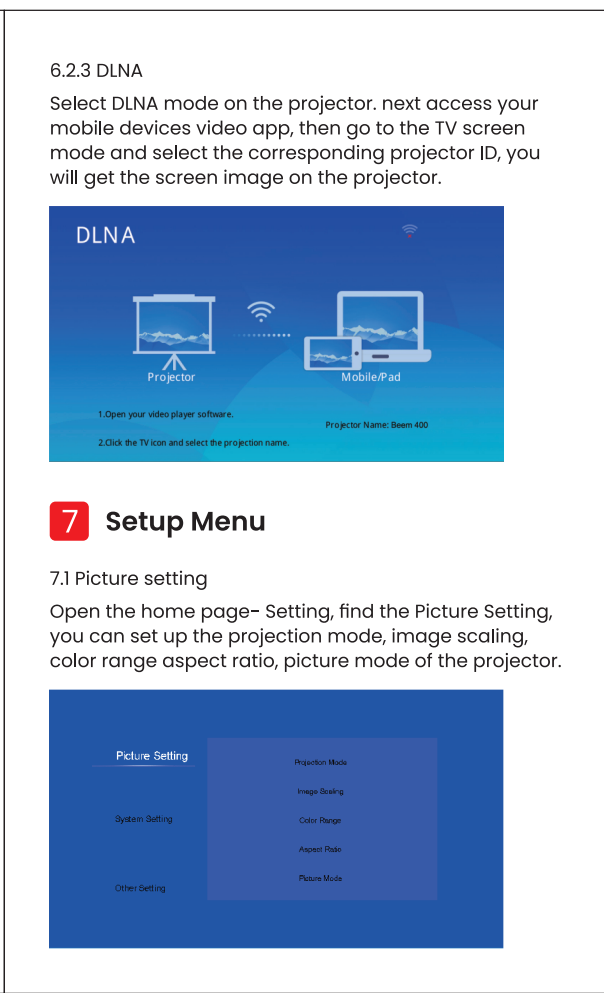

9 Product Parameter

Imaging technology	TFT LCD
Resolution	1280*720
Maximum compatible resolution	1920*1080
Light	LED
Focus mode	Electronic focus
Projection distance	1.2-5.7 M
Screen size	40-200 inches
Aspect ratio	16:9
Power input	18V/3.42A
Input	USB*/HDMI*
Output	Earphone
Speaker	40x31x2
Unit size	ø118.178mm
Net weight	0.79KG
Projector radio	1.36:1

Projector distance & size

Angles: 40°, 50°, 68°, 200"

Distances: 1.2, 1.5, 2, 5.7 (m)

Note: Due to optics error of 3%, the data above is for reference only, please use actual measurement when install the device.

PORTRONICS

BEEM 400
HD Projector With Screen Mirroring