

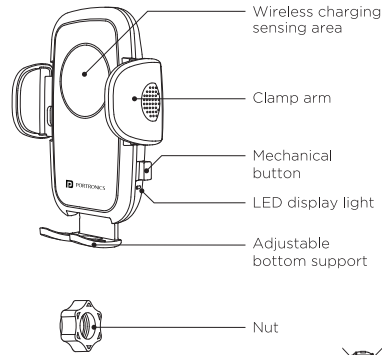

**CHARGE CLAMP 2**  
Wireless Charging Car Holder

User Manual

**Product Overview**



**Dashboard base**

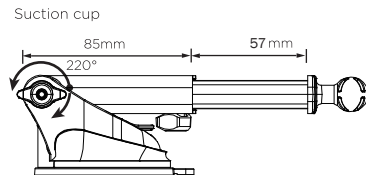

**Parameter**

Material: ABS  
Input: 5V==2A 9V==2A 12V==1.5A  
Output: 5W/7.5W/10W/15W (Max)  
Input port: Type-C  
Applicable size: 4.5-6.8 inches

**Component assembly [Dashboard]**

**Step 1:**  
Connect the dashboard accessories to the product, put the universal ball into the nut, and then insert it into the back bolt of the device; tightening the nut clockwise;

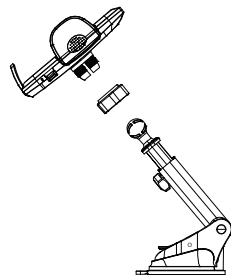

**Step 2:**

Clean the windshield or dashboard where you need to install the car mount with a wet cloth, and wait for it to dry;

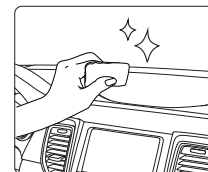

**Step 3:**

Fix the suction cup base on the dashboard, and then tighten the fixing knob of the base to fix it.

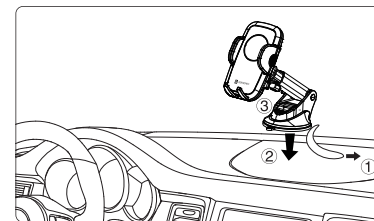

**Instructions**

1. Connect the holder with the car charger by the Type-C charging cable in the package.

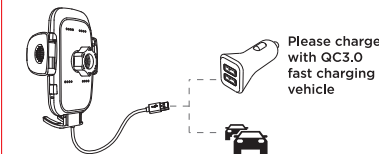

Please charge with QC3.0 fast charging vehicle

2. Press the side mechanical button to open the clamping arm;

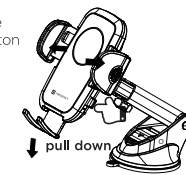

**Manually Adjust the Charging Gear**

**1Gear:**

① iPhone 12Mini, iPhone 8.

**2Gear:**

① iPhone X, iPhone XS, iPhone 11 Pro, iPhone 12, iPhone 12 Pro.  
② Samsung S10e, S9.

**3Gear:**

① iPhone XR, iPhone 11, iPhone 8Plus, iPhone XS Max, iPhone 11 Pro Max,  
② Samsung S8, Note10, S9+, S10, S10+, Note10, S21.  
③ HUAWEI P30 Pro, P40 Pro, P40 Pro+, Mate20 Pro, Mate30 Pro, Mate40.

**4Gear:**

① iPhone 12Pro Max.  
② Samsung S8+, Note8, Note9, Note10+, Note20, Note20 Ultra, S20, S20 Ultra, S20+, S21, S21 Ultra.  
③ HUAWEI Mate30, Mate40Pro, Mate40Pro+.

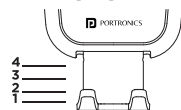

Three gears can be adjusted manually

**FAQ**

**Q:** Why can't the mobile phone be charged after connecting with the device?

**A:**

- Please check whether the mobile phone supports wireless charging function;
- Please check whether the wireless car charger holder is powered on;
- If there are no above problems, please check whether the coil circle central of the holder is aligned with the coil center of the mobile phone. And if not, please stretch the bottom support to adjust the position to align with the charging sensing area.
- Please contact the customer service if this device still can't support charging it.

**Attention**

- This product is suitable for -20 75 degree temperature environment
- Suitable for use in sealed (non-breathable) automotive instrument panels, such as: plastic panels, EVA surfaces; can not be used on leather, textile flannel surfaces
- The suction position of the suction cup is flat (not curved or meandered), and the surface texture should not be too rough (the groove width is less than 0.5mm thickness)
- The glue suction cup should be kept clean. After the surface is dirty, it can be washed with water, dried and then used
- Suction plate pressure valve keeps open when packaged and not in use, ensuring product life
- Remove the suction cup by using the pull tab

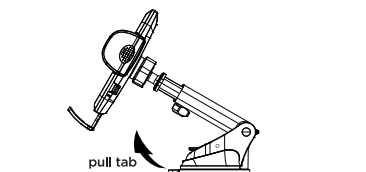

**Warning**

- Do not dismantle the product or refit it by yourself.
- Do not put this product in a humid environment.
- Please do not charge the product near the heat source or around it.
- Do not let water or other liquids flow into the internal interface of this product, otherwise it may cause damage to the product.
- Do not install the wireless charger on the airbag cover or airbag deployment area.
- Please remove the metal and magnetic protective case or card (such as bank card) from your device when charging it.
- It is normal to generate heat when charging and will not affect the performance of the product. But if you feel that the phone or the product is overheated, please disconnect the power supply and charge it after cooling down.
- Avoid using the bent or damaged USB cables please.

3. Put the mobile phone into the holder and press the clamping arms on both sides to clamp it.

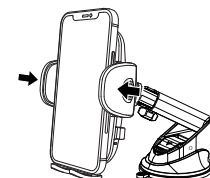

**Indicator function**

Power on	The red and blue lights flash.
Standby	The red light keeps on.
Charging	The blue light flashes slowly.
FOD(Foreign body detection)	The red light flashes quickly.