



HARMONICS X2
Wireless Stereo Headset

User Manual

Thank you for purchasing our products. This user manual contains instructions for setting up your Portronics Harmonics X2 with ease, so please read our guide carefully, and keep it for future reference.

Package Contains :

1. Harmonics X2
2. Charging Cable Type C
3. User Manual

Product Description :

- A. Volume Down/Previous Track
- B. (MFB) Multifunction Button
- C. Volume Up/Next Track
- D. Type C Charging Port
- E. EQ Switch

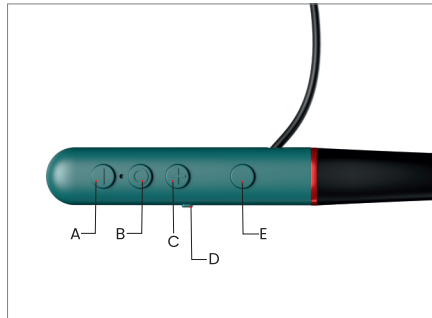

Bluetooth Connectivity :

- Turn the earphones on by holding the MFB, the blue and red indicator flashes alternately. You have entered into pairing mode.
- Search bluetooth : Keep the neckband closed to mobile within 1m range.
- Pairing successful When there is a product named Harmonics X2 spotted in your Bluetooth search, select the device. Neckband indicator will flash with blue light to indicate a successful connection.
- Harmonics X2 will automatically be connected to the paired device, every time the device is switched on.

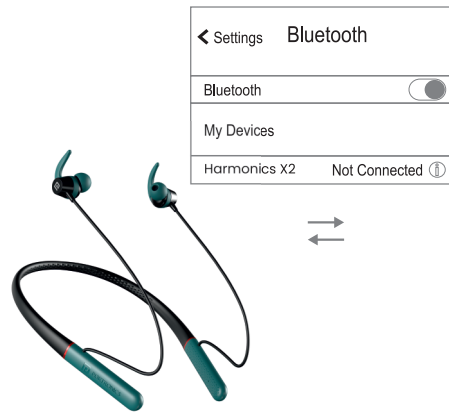

Button	Affect	Current State	Button Operation	Prompt Sound
	Automatic Shutdown	Power On	It will shutdown automatically if without Bluetooth connection for 10 Mins after power on.	Power Off
	Pairing	Connection Failed	Enter pairing state automatically	
		Power Off		
		Power On		
Vol+	Volume Up	When play music	Short press the "+" Button	"Drip" Maximum prompt tone "Drip"
	Next Track		Long press the "+" Button	
Vol-	Volume Down	When play music	Short press the "-" Button	"Drip" Minimum prompt tone "Drip"
	Previous Track		Long press the "-" Button	
MFB	Play/Pause	Play music	Short press the MFB once	
	Answer	Incoming Calls	Short press the MFB once	Prompt Voice
	Hang Up	Ongoing Calls	Short press the MFB once	
	Reject	Incoming Calls	Long press the MFB for 1 sec	Deep
	Transfer a call	Ongoing Calls	Long press the MFB for 1 sec	Deep

EQ Mode	Game Mode	Connection State	Perform a double-click action to EQ switch activate "game mode" with an audible prompt saying "game mode." To exit the game mode, simply double-click again	Game mode On Game mode off
MFB	Voice Assistant	Connection State	Double press the MFB	
MFB	Re-dial phone number	Connection State	Triple press MFB	Deep
EQ Button	Switch to EQ	Power on status	Triple press EQ Switch button to switch	Bass Mode
EQ Button	Switch to EQ	Power on status	Triple press EQ Switch button to switch	Music Mode

Product Specifications :

- BT Version : V5.3
- Driver Size : 10mm
- Wireless Frequency : 2402MHz-2480MHz
- Working Distance : 10m
- Charging Port : Type-C (5V/1A)
- Playtime : Upto 40 hrs.
- Working Temperature Range : -20°C -50°C
- Water Resistant : IPX5

Cautions

1. Avoid extreme heat, cold and humidity.
2. Avoid dropping or crushing the Earphones, stressing the cable by rapid pulling or extreme force, or bending the cable at sharp angle.
3. Wax may build up in the Earphones tips, lowering the sound quality Carefully remove the wax with a cotton swab or other small tool to improve the sound quality.
4. If you experience discomfort or pain, try lowering the volume or discontinuing use temporarily.



www.portronics.com

For Support

Visit : www.portronics.com

Email : help@portronics.com

Contact No. : +91 9555245245, 011-42413131

(Working Hrs. : Monday - Saturday 10:00am - 6:00pm)



E-Waste Management
E: info@3irecycler.com
For E-Waste & RoHS compliance refer to www.portronics.com/ewaste