



PURE SOUND 106

120W Bluetooth Soundbar with Wired Subwoofer



USER MANUAL

Package Contents

- 1. Soundbar IN
- 2. Wired Subwoofer IN
- 3. Remote Control IN
- 4. User Manual IN
- 5. Audio Cable IN

Remote Control

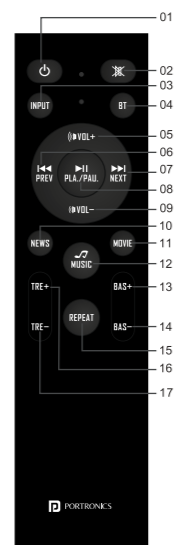

- **01 STANDBY:** When under standby mode, single press this key to start the working state when under working state, single press this key to Shut down into standby state.
- **02 MUTE:** Under all working states, single press this key to switch on and off the system of "mute" function.
- **03 INPUT:** When working, simply press this button for USB, AUX, BT, HDMI input loop switch.
- **04 BT:** Press this button to select BT playback.
- **05 VOL+:** Single press this key to increase volume.
- **06 PREV:** When under USB, BT status, single press this key to select "previous song" function: This function is invalid under other modes.
- **07 NEXT:** When under USB, BT status, single press this key to select "next song" function; This function is invalid under other modes.
- **08 PLAY/PAUSE:** When under USB or BT state, single press this key to play or Pause. When under BT state, long press the "Play/Pause" button should be able to disconnect or connect back to BT device.
- **09 VOL-:** Single press to decrease the volume.
- **10 NEWS:** Under all working states, single press this key into EQ1 sound mode: News mode
- **11 MOVIE:** Under all working states, single press this key into EQ2 sound mode: Movie mode
- **12 MUSIC:** Under all working states, single press this key into

Eq3 Sound mode: Music mode

- **13 BAS+:** Single press to raise the system bass.
- **14 BAS-:** Single press to lower the system bass.
- **15 REPEAT FUNCTION:** ONE: Repeat current song
ALL: Repeat all songs.
SHUF: Shuffle the songs and play again and again.
OFF: Play every song once, use their order.
- **16 TRE+:** Single or long press this key to increase the treble.
- **17 TRE-:** Single or long press this key to decrease the treble.

Remark:

1. Do not expose the apparatus to high temperature, weather, moisture.
2. Do not attempt to disassemble the product to avoid electric shock only professional should perform service.
3. Please turn off the power and pull out the plug when you do not use this product.

Control Panel Diagram:

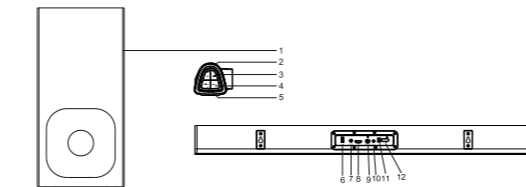

- 1 Subwoofer
- 2 MODE
- 3 Play/Pause
- 4 VOL-/Prev. Music
- 5 VOL+/Next Music
- 6 USB Input
- 7 AUX IN
- 8 H-ARC
- 9 BASS Out
- 10 DC in
- 11 Power ON Switch
- 12 AC IN

AC POWER

IMPORTANT NOTES

- Make sure the power supply is proper and never handle the power cord or its plug with wet hands when plugging into, or unplugging from an outlet.
 - Ensure that the main power switch is in the "OFF" position before connecting the AC power cord to the power supply to avoid damage to the unit.
- A damaged power cord can easily cause an electric shock or fire hazard; Never use a power cord after it has been damaged.

Battery Installation

- Open the battery flap
 - Insert one battery without the polarity reversed.
 - Close the battery flap
 - Keep within 5 meter range, 30 degree angle while aiming at the unit.
- Precautionary note:
Remove the battery when the unit is not being used for a long period of time.
- Add only AAA batteries.

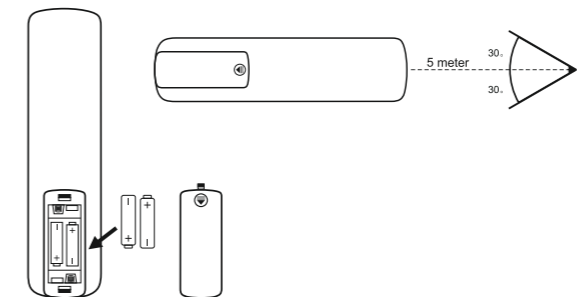

Back Panel Connection Diagram:

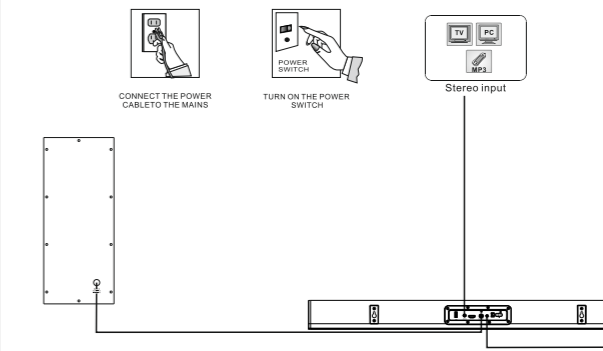

Product Specifications:

- **Compatible with:** TV, DVD, PC, Laptop, Tablet, Mobile, MP3 player etc.
- **Channel:** 2.1
- **Source input:** USB/BT/AUX/HDMI
- **Device supports:** USB
- **Bluetooth Version:** V5.3
- **Bluetooth Range:** 10M (Without Barrier)
- **Frequency response:** 35Hz - 20KHz
- **Dimension:** BAR: W600*D71*H71mm, SW: W146*D268*H324mm
- **Power consumption (St.By):** ≤1.5W

- **Power consumption:** 60W
- **Power supply:** AC100-240V 50/60Hz_DC15V4A
- **Remote control:** Yes
- **Remote control range:** 5m
- **Remote control angle:** 30°
- **Accessories:** User Manual, Audio Cable, Remote control



www.portronics.com

For Support

Visit: www.portronics.com

Email: help@portronics.com

Contact No.: +91 9555245245, 011-42413131

(Working Hrs.: Monday - Saturday 10:00am - 6:00pm)



E-waste Management

Email: info@3rrecycler.com

For E-waste & ROHS compliance refer to <http://www.portronics.com/ewaste.html>